

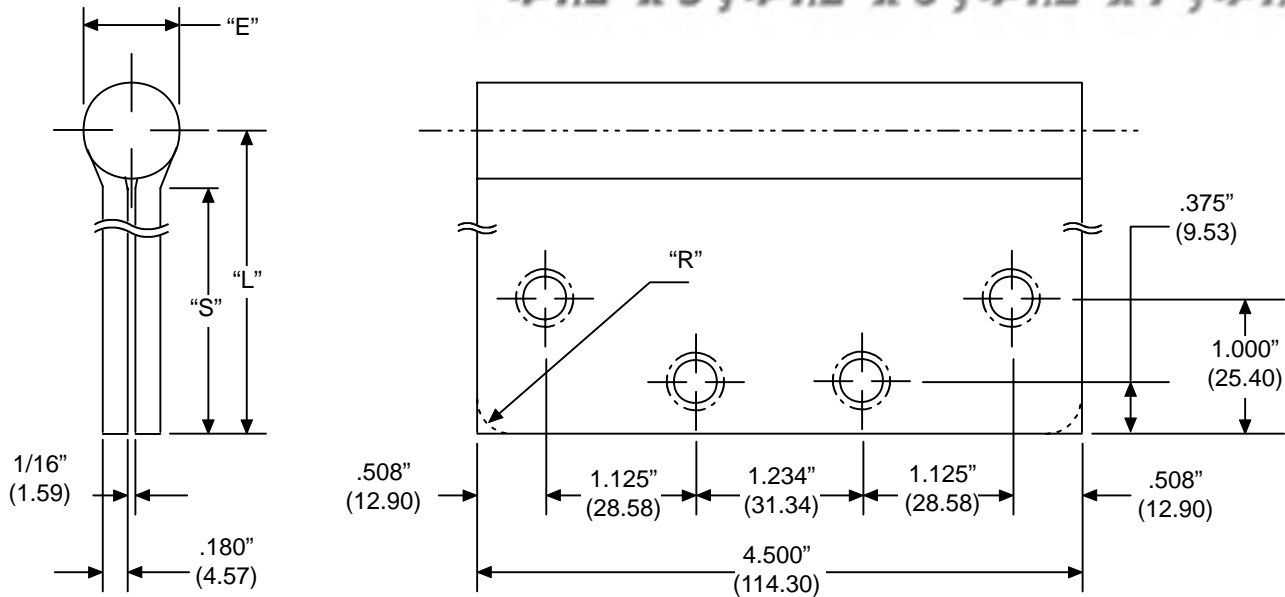

**FULL MORTISE HEAVY WEIGHT TEMPLATE**

WT4B - WT4C - WT4F

4-1/2" x 5", 4-1/2" x 6", 4-1/2" x 7", 4-1/2" x 8"



Part Number			Gauge of Metal	"E" Outside Dia.	"L" Leaf Width	"S" Swage Line	"R" Corner Radius
Steel	Brass	Stainless					
WT4B81/ WT4C81	WT4B21/ WT4C21	WT4B51/ WT4C51	.180"	.720"	2.50"	2.07"	Square, 1/4", 5/8"
WT4B81/ WT4C81	WT4B21/ WT4C21	WT4B51/ WT4C51	.180"	.720"	3.00"	2.57"	Square, 1/4", 5/8"
WT4B81/ WT4C81	WT4B21/ WT4C21	WT4B51/ WT4C51	.180"	.720"	3.50"	3.07"	Square, 1/4", 5/8"
WT4B81/ WT4C81	WT4B21/ WT4C21	WT4B51/ WT4C51	.180"	.720"	4.00"	3.57"	Square, 1/4", 5/8"

**NOTE:**

- 1 screw pack includes all machine screws (24), and 1/2 wood screws (12). ATMS & AWS also available.
- Screw size: FHMS - 12-24 x 1/2"  
FHWS - 12 x 1-1/4"
- All hinges are ANSI template.