

6200 Series strikes for mortise or cylindrical devices

Overview

Von Duprin electric strikes are known for their reliability, durability and security. The 6200 Series is designed to withstand abuse. Its heavy-duty stainless steel construction is fully UL1034 and UL10C listed.

6200 Series electric strikes are designed for use with a variety of mortise or cylindrical locksets. It interfaces with the latch mechanism of the exit device. The 6200 Series movable lip (keeper) allows a door to open, even when the latch bolt is extended. This feature, called remote release provides added benefits such as increased convenience and efficiency. The 6200 Series also provides added security and traffic control.

6200 Series electric strikes can be used for retrofit applications or new construction. To assure the proper selection of an electric strike on new applications, lockset compatibility charts are shown below. When using a lockset not listed or when retrofitting a strike to an existing application, please contact Von Duprin Technical Support for application assistance.

Features and benefits

- Non handed design provides greater flexibility
- Strike box is adjustable to compensate for misalignment of the door or frame
- Two piece plug connectors are furnished for ease of installation and for removal during strike servicing
- UL1034 Burglary-Resistant and UL10C Electric Strike for Fire Door
- Six finishes available to suite with existing hardware
- Durable stainless steel construction
- 24 VDC standard with 12 VDC and AC operation optional



6200 Series power requirements

Models	Voltage	Current	Duty	Amps	Ohms
All	12V	DC	Continuous	0.60	21
All	16V	DC	Continuous	0.40	38
All	24V	DC	Continuous	0.33	83
All	28V	DC	Continuous	0.25	111

Continuous duty = Energized 1 minute or more

Cylindrical lockset compatibility^{1,2,3}

6211, 6211AL, 6211WF, 6212, 6213, 6214, 6215, 6221, 6222, 6223, 6224, 6224AL, 6225 and 6226 Strikes

Manufacturer	Cylindrical latchbolt projection
Baldwin	$\frac{1}{2}'' - \frac{3}{4}''$ (13mm - 19mm)
Best	$\frac{3}{8}'' - \frac{3}{4}''$ (10mm - 19mm)
Corbin	$\frac{1}{2}'' - \frac{3}{4}''$ (13mm - 19mm)
Falcon	$\frac{1}{2}'' - \frac{3}{4}''$ (13mm - 19mm)
Russwin	$\frac{1}{2}'' - \frac{3}{4}''$ (13mm - 19mm)
Sargent	$\frac{1}{2}'' - \frac{3}{4}''$ (13mm - 19mm)
Schlage	$\frac{3}{8}'' - \frac{3}{4}''$ (10mm - 19mm)
Yale	$\frac{1}{2}'' - \frac{3}{4}''$ (13mm - 19mm)

Mortise lockset compatibility^{1,2,3}

6211, 6211AL, 6211WF, 6212, 6213, 6214, 6215, 6221, 6222, 6223, 6224, 6224AL, 6225 and 6226 Strikes

Manufacturer	Model number
Von Duprin	7500
Adams Rite	4510, 4710
Baldwin	6000
Best	24H, 30H
Corbin	9000
Falcon	M2300, M2500, M2600, M3300, M3500, M3600
Precision	Mortise
Russwin	Mortise
Sargent	7700, 8100, 9000
Schlage	L9000, K30, K40, K50, K60
Yale	7030, 7130, 8600, 8700

Mortise lockset compatibility^{1,3}

6210

Manufacturer	Model number
Von Duprin	7500
Best	30H (not 45H/47H)
Corbin/Russwin	ML2200, 5000, 9000, CR2200 (not 2000)
Falcon	M100, M200, M300, M400, M500, M600
Sargent	7700, 8100 (not 7800/8200)
Schlage	L9000
Yale	8700 (not 8800)

1. Von Duprin cannot guarantee compatibility as other manufacturer's designs may change without notice.
2. Signalling may not function when using $\frac{3}{8}''$ (10mm) throw bolt. Deadlocking cannot be guaranteed with all locks.
3. When using a lockset not listed or when retrofitting a strike to an existing application, please contact Von Duprin Technical Support for assistance.

6200 Series strikes for mortise or cylindrical devices

Wiring

AC

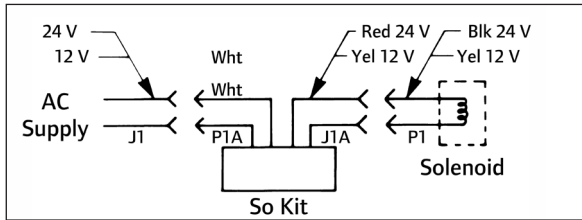

AC with buzzer

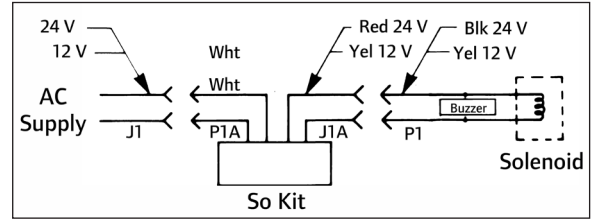

DC

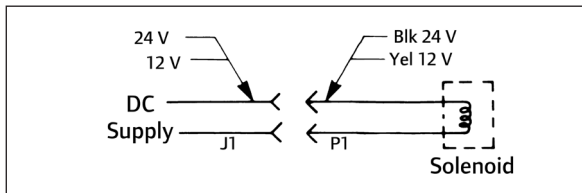

DC with buzzer

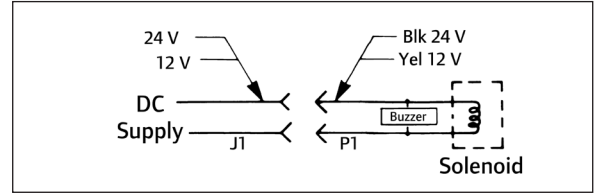

Optional DS (FSE shown)

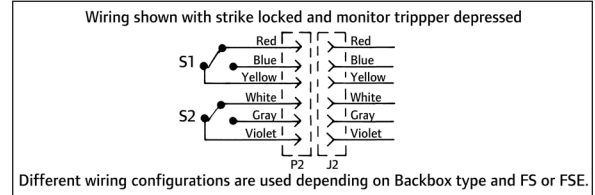

Model Specifications



Model number	6210	6211	6211AL	6211WF	6212
Retrofits model	n/a	VD 3140, FA 712	FA 722	FA 732	VD 3146
Latchbolt throw	3/4"	3/4"	3/4"	3/4"	3/4"
Face plate length	4 7/8"	4 7/8"	4 7/8"	4 7/8"	6 3/8"
Backbox depth	1 3/4"	1 11/16"	1 11/16"	4 1/2"	1 21/32"
Lockset	Mortise without deadbolt	•	•	•	•
	Mortise with deadbolt 1" throw	---	---	---	---
	Cylindrical	---	•	•	•
Number of doors	Single	•	•	•	•
	Pair	---	---	---	---
Door and frame type	Hollow metal	•	•	---	•
	Aluminum	•	•	---	•
	Wood	---	---	---	•
Options	DS or DS-LC (dual monitor switches)	•	•	•	•
	EB (Entry buzzer - fail secure only)	•	•	•	•
Certifications	UL1034	•	•	•	•
	UL10C	3 hour	3 hour	3 hour	3 hour
Application notes	1	2	---	2, 4	3

Note: 16 VDC and 28 VDC solenoid are sold as replacement parts for existing strikes. Please contact customer care for details..

Application notes:

- For use with ANSI prep at standard height. Strike pocket inserts are provided to accommodate different manufacturers deadlocking trigger locations.
- For use on new installations with mortise locks without deadbolt or cylindrical locks on single door, hollow metal frame applications. Designed to replace Von Duprin 3140 or Folger Adam 712.
- Fits modified ANSI 115.2 cutout. Designed to replace Von Duprin 3146.
- Wood frame horizontal solenoid location differs from Folger Adam. May require frame preop modification when retrofitting.

6200 Series strikes for mortise or cylindrical devices

Model Specifications

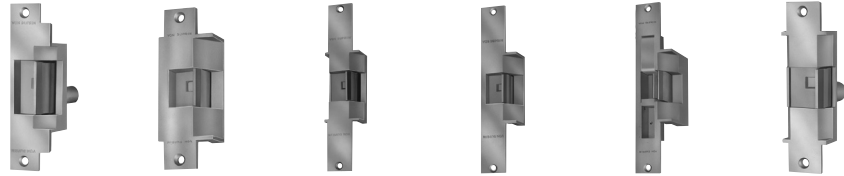

Model #	6212WF	6213	6214	6215	6216	6221
Retrofits model	n/a	VD 3041, 3042, 3061, 3062	FA 310-2 3/4	FA 310-2	FA 310-3-1	VD 3071 / 3072
Latchbolt throw	3/4"	3/4"	3/4"	3/4"	3/4"	3/4"
Face plate length	6 3/8"	6"	9"	9"	9"	6"
Backbox depth	4 1/2"	2 1/2"	2"	1 5/8"	2 7/8"	4 3/4"
Lockset	Mortise without deadbolt	*	*	*	---	*
	Mortise with deadbolt 1" throw	---	---	---	*	---
	Cylindrical	*	*	*	---	*
Number of doors	Single	*	*	*	*	---
	Pair	---	---	---	---	*
Door and frame type	Hollow metal	---	*	*	*	*
	Aluminum	---	*	*	*	*
	Wood	*	See note 1 below			*
Options	DS or DS-LC (dual monitor switches)	*	*	*	*	---
	EB (Entry buzzer - fail secure only)	*	*	*	*	*
	28 VDC AC rectifier kit	*	*	*	*	*
	16 VDC solenoid	*	*	*	*	*
Certifications	UL1034	*	*	*	*	*
	UL10C	3 hour	3 hour	3 hour	3 hour	3 hour*
Application notes	---	1	1	1	2	3

* When pair door has inactive leaf.



Model #	6222	6223	6224	6224AL	6225	6226
Retrofits model	FA 310-2 3/4 OB	VD 3091 / 3092	FA 310-2 3/4	FA 310-2RF	FA 310-2 OB	FA 310-2
Latchbolt throw	3/4"	3/4"	3/4"	3/4"	3/4"	3/4"
Face plate length	9"	6"	9"	9"	9"	9"
Backbox depth	2"	4 1/2"	2"	1 5/8"	1 5/8"	1 5/8"
Lockset	Mortise without deadbolt	*	*	*	*	*
	Mortise with deadbolt 1" throw	---	---	---	---	---
	Cylindrical	*	*	*	*	*
Number of doors	Single	---	---	---	---	---
	Pair	*	*	*	*	*
Door and frame type	Hollow metal	*	*	---	*	*
	Aluminum	*	*	*	*	*
	Wood	---	*	---	---	---
Options	DS or DS-LC (dual monitor switches)	---	*	*	---	*
	EB (Entry buzzer - fail secure only)	*	*	*	*	*
	28 VDC AC rectifier kit	*	*	*	*	*
	16 VDC solenoid	*	*	*	*	*
Certifications	UL1034	*	*	*	*	*
	UL10C	3 hour*	3 hour*	3 hour*	3 hour*	3 hour*
Application notes	4	5	6	7	8	9

* When pair door has inactive leaf.

- Includes wood frame for retrofit applications.
- Deadbolt must be manually operated.
- Open back electric strike for use on 1 3/4" (44 mm) thick double door applications. 4 3/4" (120 mm) minimum stile required. For a concealed vertical rod and mortise device combination, specify "A" backbox.
- Open back electric strike for use on 1 3/4" (44 mm) thick double door applications.
- Closed back electric strike for use on 1 3/4" (44 mm) thick double door applications. 4 3/4" (120 mm) minimum stile required. For a concealed vertical rod and mortise device combination specify "A" backbox.
- Closed back electric strike for use on 1 3/4" (44 mm) or 2 1/4" (57 mm) thick double door applications.
- Closed back electric strike for use on 1 3/4" (44 mm) or 2 1/4" (57 mm) thick aluminum double door applications.
- Open back electric strike for use on 1 3/4" (44 mm) thick double door applications.
- Closed back electric strike for use on 1 3/4" (44 mm) or 2 1/4" (57 mm) thick double door applications.

6200 Series strikes dimensions

Dimensions

6210

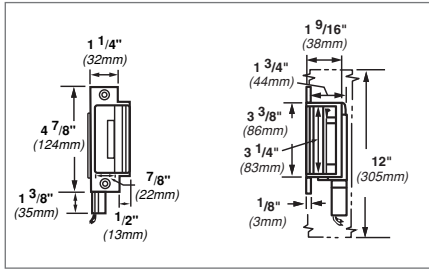

6212

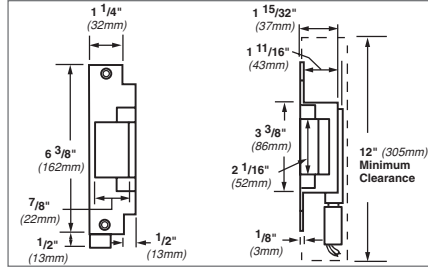

6215

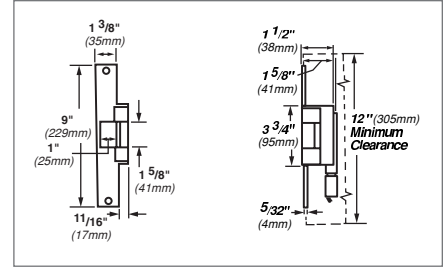

6211

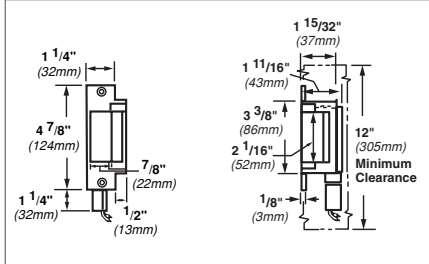

6212WF

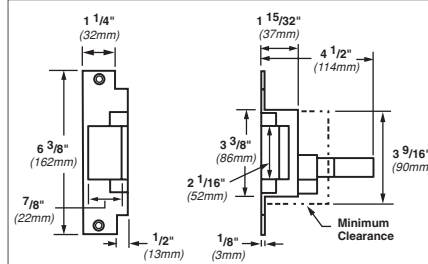

6216

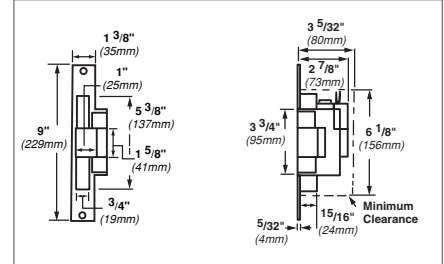

6211AL

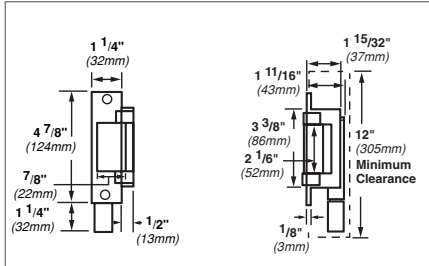

6213

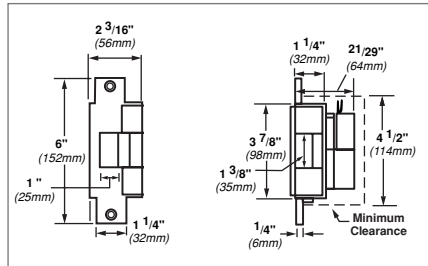

6221

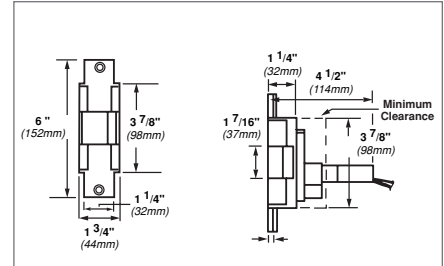

6211WF

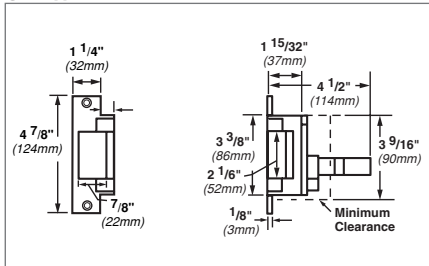

6214

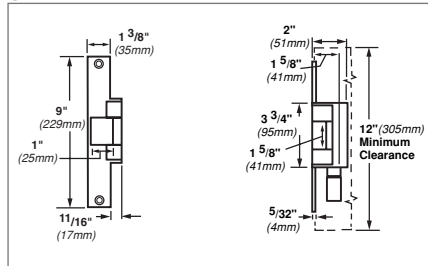

6222

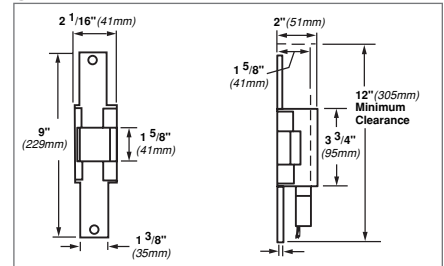

6200 Series strikes dimensions

6200 Series strikes dimensions

Dimensions

6223

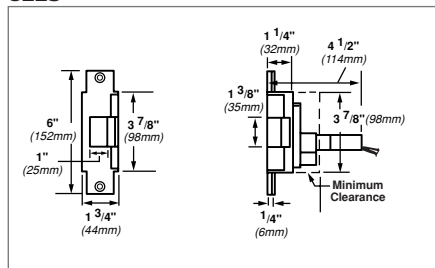

6224AL

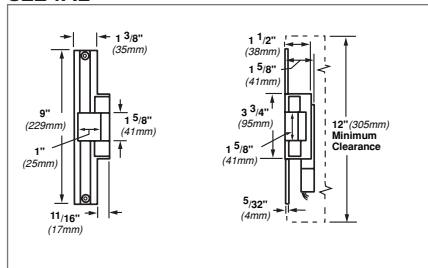

6126

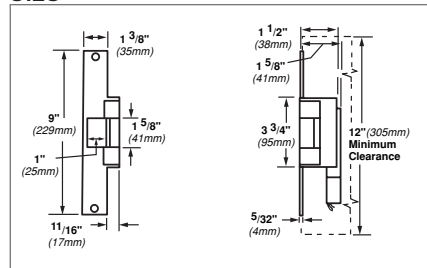

6224

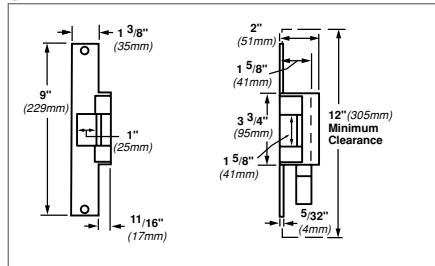

6225

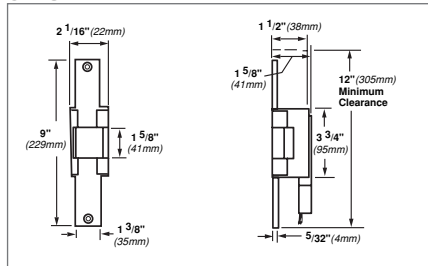

Ordering information

6210 - FSE - DS - 24 - S024 - US3 - EB - CON

Model	Power failure mode	Dual switch*	Voltage	Rectifier kit*	Finish	Buzzer*	Allegion Connect*
1	2	3	4	5	6	7	8

* Optional

Selections correspond with the numbers above

1	Model	2	Power failure mode	6	Finish US number/Von Duprin number
6210	See chart on page 13 to make the proper selection	FSE	Fail-secure. Requires power to be applied to unlock the strike lip. On loss of power, the strike lip is locked. Fire-rated.	US3	Plated polished brass on stainless steel
6211	See chart on page 13 to make the proper selection	FS	Fail-safe. Requires power to be applied to lock the strike lip. On loss of power, the strike lip is unlocked. Non-fire-rated.	US4 US10 US10B	Plated dull brass on stainless steel Plated dull bronze on stainless steel
6211AL	See chart on page 13 to make the proper selection	3	Dual switch (optional)	US32 US32D	Stainless steel, polished Stainless steel, satin
6211WF	See chart on page 13 to make the proper selection	DS	Monitors latch bolt and lock status. DS switches rated at 24 VDC 50 milliamperes - 2 amps.	7	Buzzer (optional)
6212	See chart on page 13 to make the proper selection	DS-LC	Optional for computer monitoring. Monitors latch bolt & lock status. DS-LS switches rated 24 VDC 50 milliamperes or less.	EB	Entry Buzzer. Only available if Fail-Secure (FSE) is specified.
6212WF	See chart on page 14 to make the proper selection	4	Voltage (VDC)	8	Allegion Connect
6213	See chart on page 14 to make the proper selection	24	Low voltage DC power	CON	Allegion Connect connector 6 in. wire extension harness available
6214	See chart on page 14 to make the proper selection	12	Low voltage DC power		
6215	See chart on page 14 to make the proper selection	If AC power is required, specify rectifier kit below.			
6216	See chart on page 14 to make the proper selection	5	Rectifier kit (optional)		
6221	See chart on page 14 to make the proper selection	SO12	Converts 12 VAC voltage to 12 VDC to operate the solenoid		
6222	See chart on page 14 to make the proper selection	S024	Converts 24 VAC voltage to 24 VDC to operate the solenoid		
6223	See chart on page 14 to make the proper selection				
6224	See chart on page 14 to make the proper selection				
6224AL	See chart on page 14 to make the proper selection				
6225	See chart on page 14 to make the proper selection				
6226	See chart on page 14 to make the proper selection				